

NOVASONAR DYNAMIC 60 GK FK NA

Invisible sound system for coverings made of gypsum plaster boards

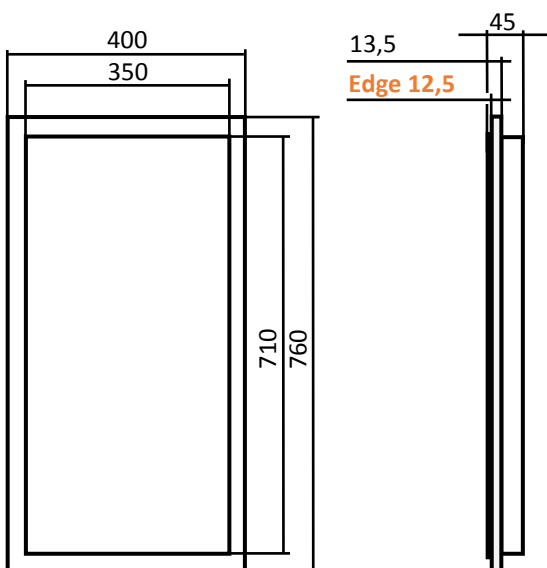

Building material and the sound system from a single production source

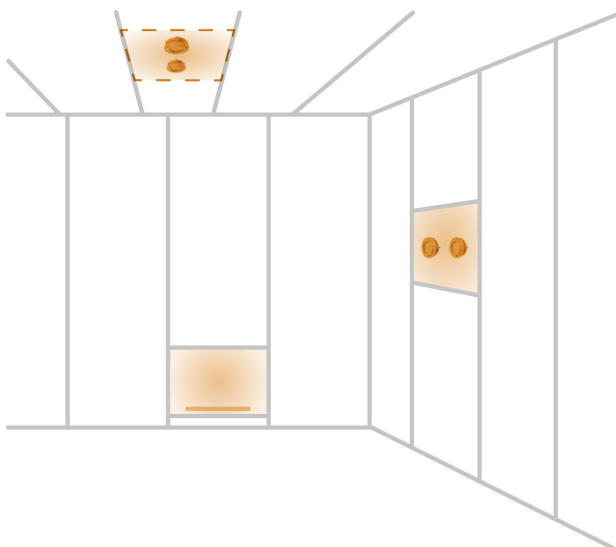

Available in the following gypsum plaster boards

Standard version: Gypsum plaster board green/
12,5 mm with flattened edge

Description / Technical data

Flat-panel loudspeaker on the principle of the bending wave transducer with a flat panel membrane, which is brought to vibration by electrical exciters mounted to the back and with an integrated frequency crossover/filter.

The loudspeaker comprises a conventional gypsum plaster board with a factory-integrated flat-panel loudspeaker. The board is stripped down to a thickness of 0,8 mm on the back in the area of the loudspeaker membrane by means of milling and thus causes sound-neutrality.

Materials and assembly do not differ from other construction materials used and as a result, there are no „alien bodies“ in the drywall.

The 12,5 mm flattened edge in combination with the one mm raised membrane provides the space for drywall tape and plaster, because plastering over the membrane is not permissible.

Factory integration of the flat-panel loudspeaker in the building material precludes any errors in installation and guarantees continuously assembly and processing technology in drywall work without material change, therefore ensuring smooth progress on the building site.

The surface can be coated with all conventional materials, such as, for example, paint, plaster techniques, wallpapers, etc.

Dimensions (standard): 400 mm x 760 mm
Building material: Gypsum plaster board
with flattened edge
Frequency response: 80 Hz – 20000 Hz
EQ: PN-integrated crossover
Dispersion: 180° x 180°
Power handling: 60 W / 6 Ω
Optional: 70/100 V
Sensitivity: 86 dB (1 w / 1 m)
Max. SPL: 104 dB (1 m)

Manufacturer: ML-Audio und Carbons GmbH
Model: Novasonar DYNAMIC 60 GK FK NA

All products subject to technical modification without prior notice. Errors excepted.